

SECTOR SNAPSHOT

AGRIBUSINESS & FOOD MANUFACTURING



MALTING PROCESS

Value-add processing, packaging, and food and beverage production close to farm supply, with strong cold-chain logistics for domestic and export markets.

'Geelong offers a rare combination of access to world-class raw materials, a capable manufacturing workforce, and proximity to export-ready infrastructure. For companies willing to invest, Geelong provides the scale, partnerships and civic support needed to grow.'

—
Vincent Lauwerier, General Manager
Australia & New Zealand, Malteurop

VALUE ADD

**\$430
MILLION**

(2023–24)

JOBS

5,324

(TOTAL, 2023–24)

EXPORTS

**\$565
MILLION**

(2023–24)

Encompasses agriculture, forestry and fishing; food and beverage manufacturing. Includes domestic and international exports. Source: NIEIR via economy.id/geelong

OPPORTUNITY HIGHLIGHTS

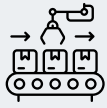

Value-add close to farm gate

Packhouse, processing, and food and beverage production serving south-west Victoria's agricultural producers, with fast refrigerated links to Melbourne's wholesale markets and national distribution.



Cold-chain and export ready

Port of Geelong supports bulk agri-trades and project cargo; direct access to Avalon Airport's cold storage air-freight facility.



Secure inputs

Industrial precincts with reliable power, gas and Class A recycled water in key locations to support intensive food production.



Research and development and skills

Deakin University's Aquaculture and Feed Innovation Laboratory, and biofactory, along with, Marcus Oldham College (agribusiness leadership) and The Gordon TAFE (food and fibre training) help firms pilot new products and scale capability.

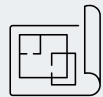

Room to grow

Large, serviced sites suit modern food manufacturing with easy access to the ring road, rail, airport and port.

Join existing businesses and organisations thriving in Geelong, including:



Malteurop
Groupe VIVESCIA



Ready to grow agribusiness
in Geelong?



Contact us:
invest@geelongcity.vic.gov.au
+61 3 5272 5272

